

D (2 : 1)

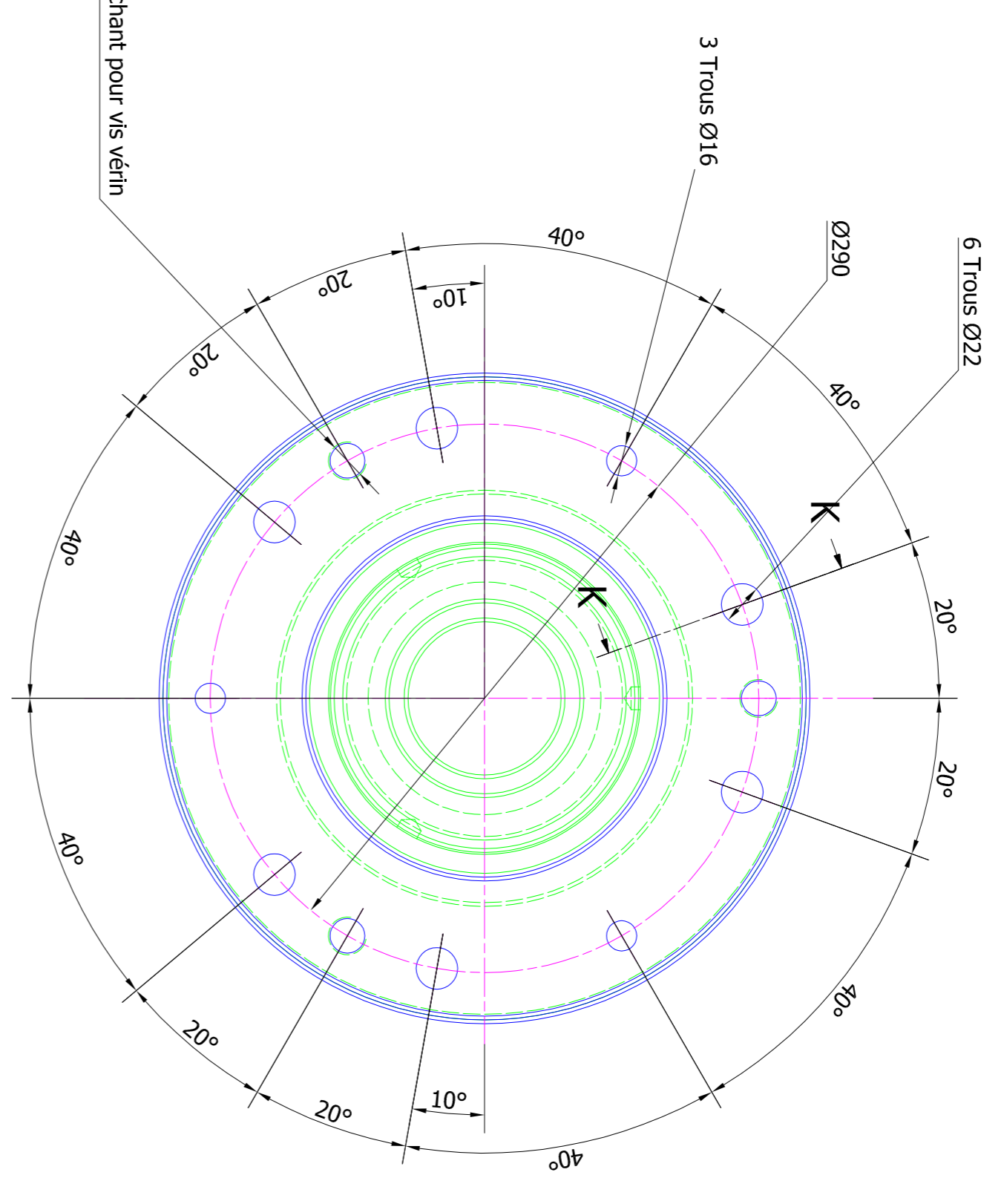

K-K (1 : 1)

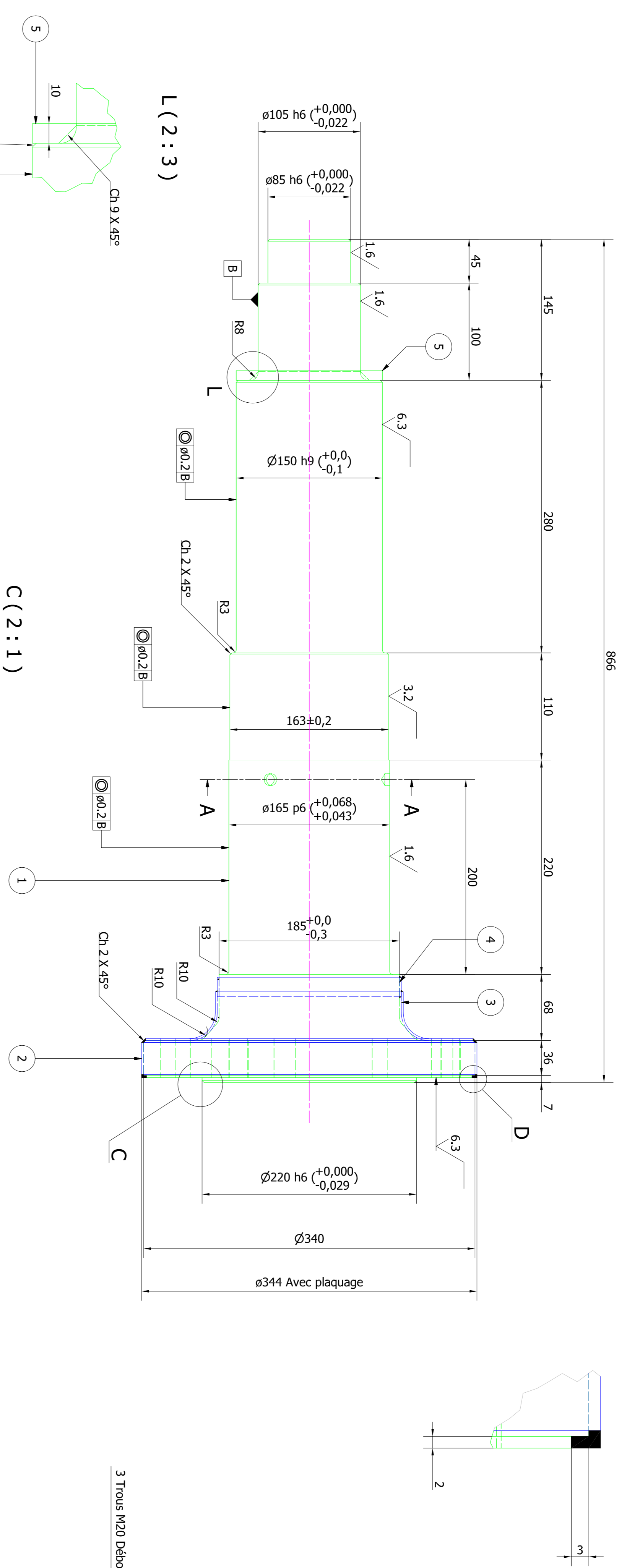
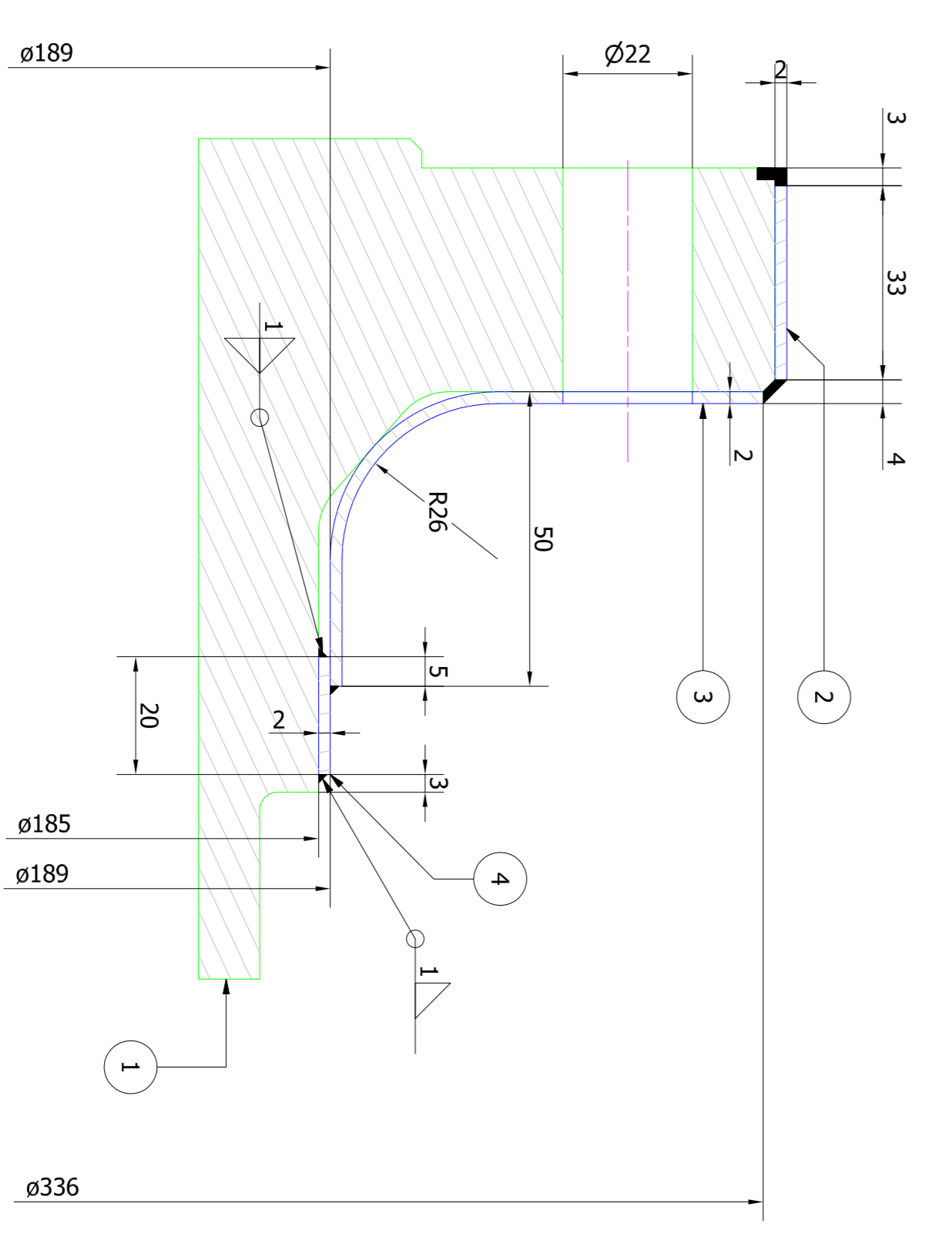

A-A (1 : 2)

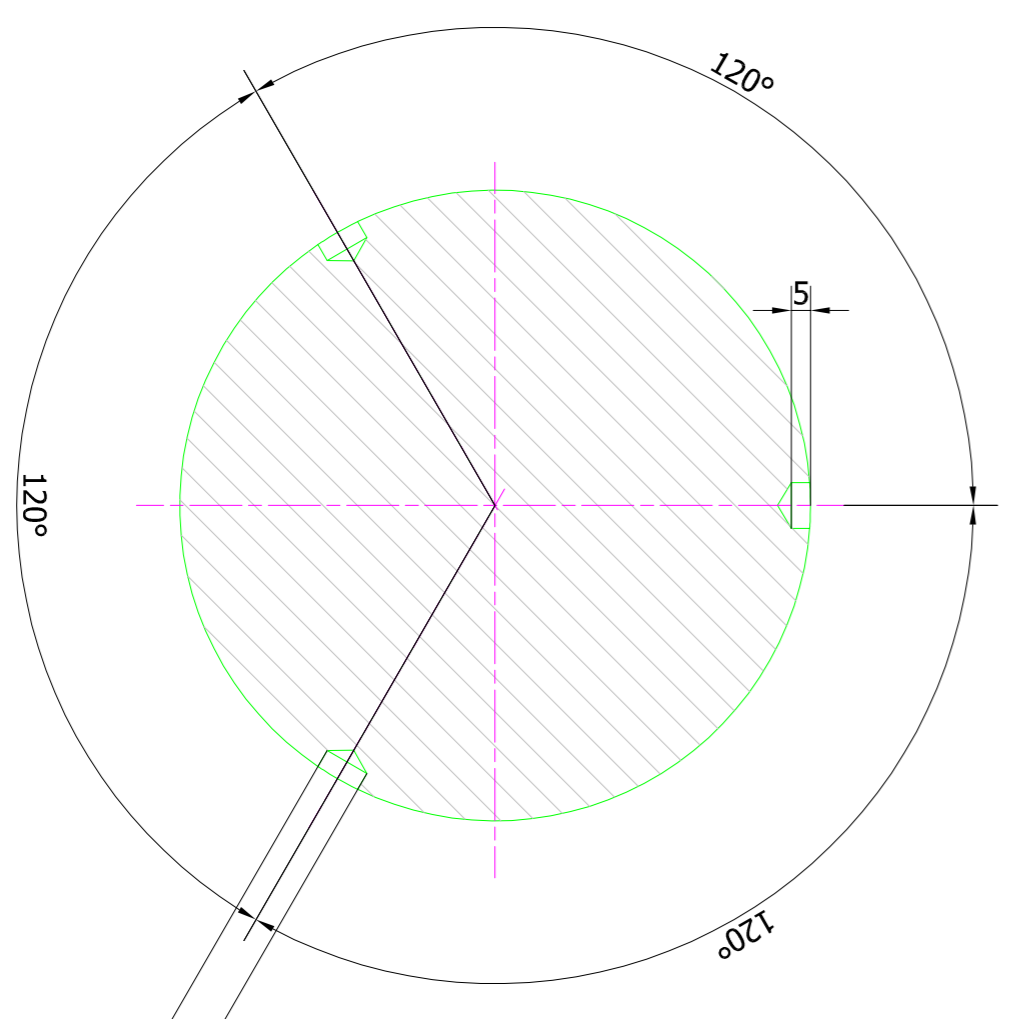

12.5 SAUF INDICATION

Poids total - Total weight : 153 Kg

DIFF	REP	QTE	DESIGNATION	DESCRIPTION	MATIERE	Poids Total Net (kg)
0	1	1	face cote commande		XC 38	148,2
0	2	1	Ribouague inox - 1 (6x 20mm)	03340.0340.033 (6x 20mm)	1.4301	0,6
0	3	1	Ribouague inox - 2 (6x 20mm)	03336.0336.033 (6x 20mm)	1.4301	1,3
0	4	1	Ribouague inox - 3 (6x 20mm)	03336.0336.033 (6x 20mm)	1.4301	1,3
0	5	1	Possible rivets	01150.0115.010	S235BRG2	0,6

REV	DATE	OBJET PAQ - CREATÉ BY	VERIFIE PAQ - CHECKED BY	APPROUVE PAQ - APPROVED BY	OBSERVATIONS
0	20/03/2011	LAZARONI	LAZARONI	LAZARONI	

Formé	Client	Ref. Client - Ref. Equipement
A1	Commande	D-1912
Equipement - Equipement		

Etat	Scale	Number of Aides	Drawings number
1:3	1:3	00	1/1

FUSEE COTE COMMANDE

2011-685-0008-00