

ŘEZ D-D
MĚŘITKO 1 : 2

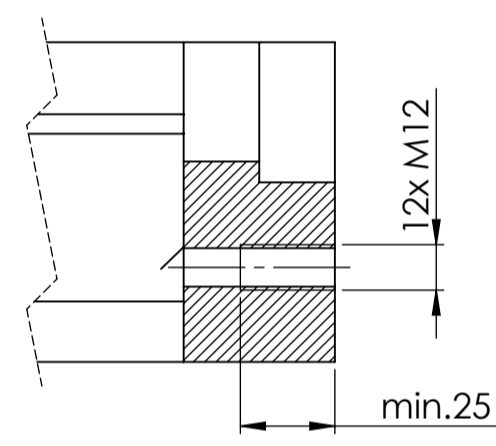

VIEW R
SCALE 1 : 4

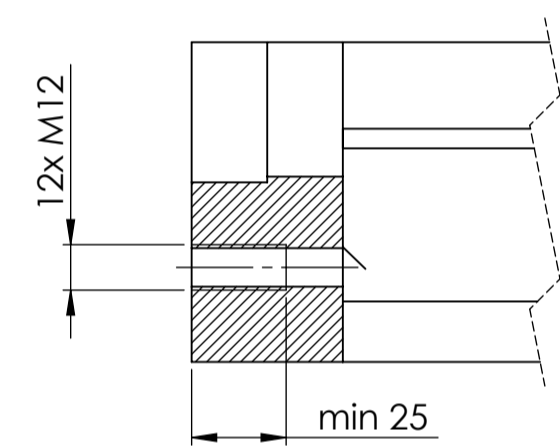
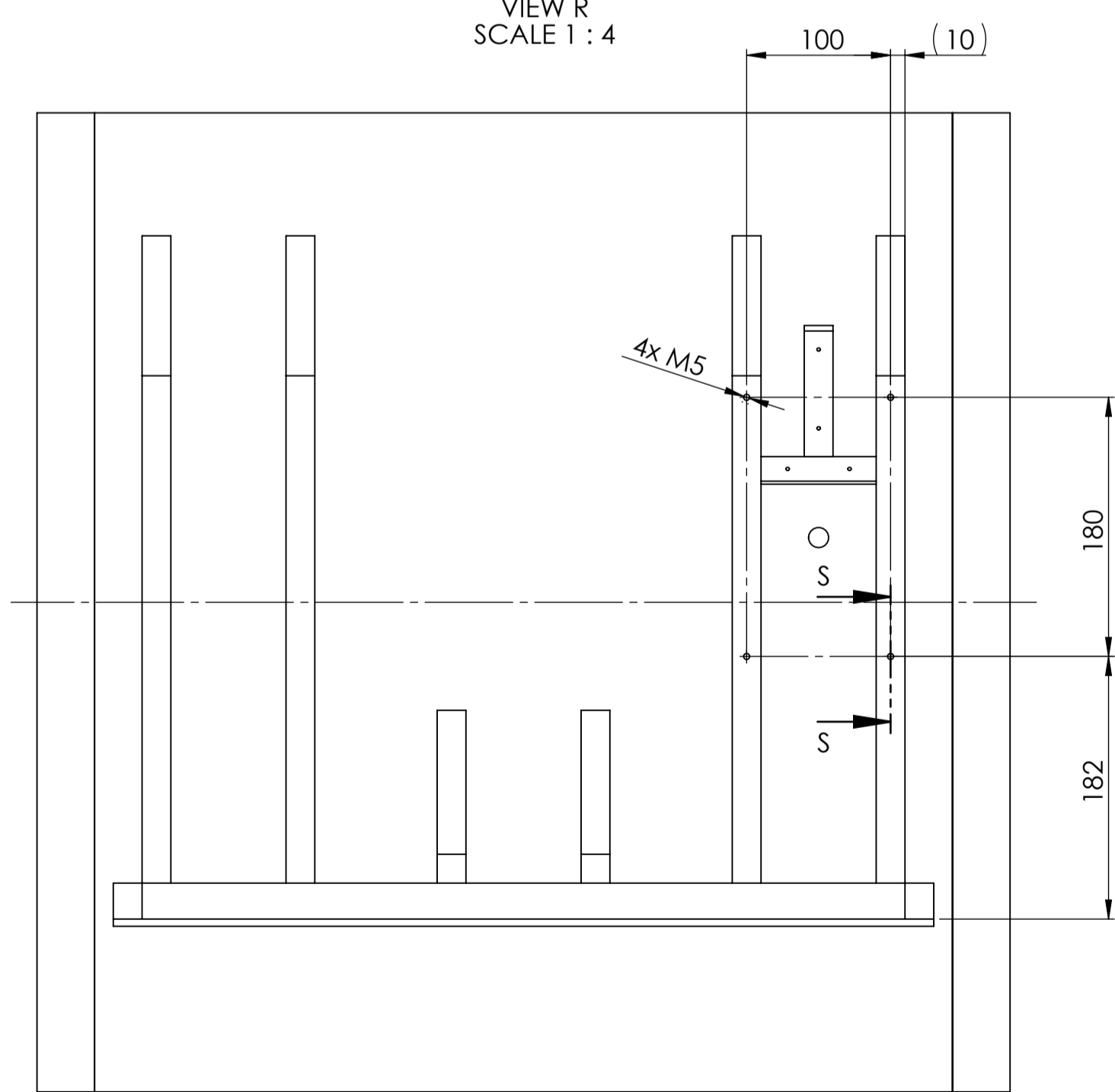

SECTION S-S
SCALE 1 : 2

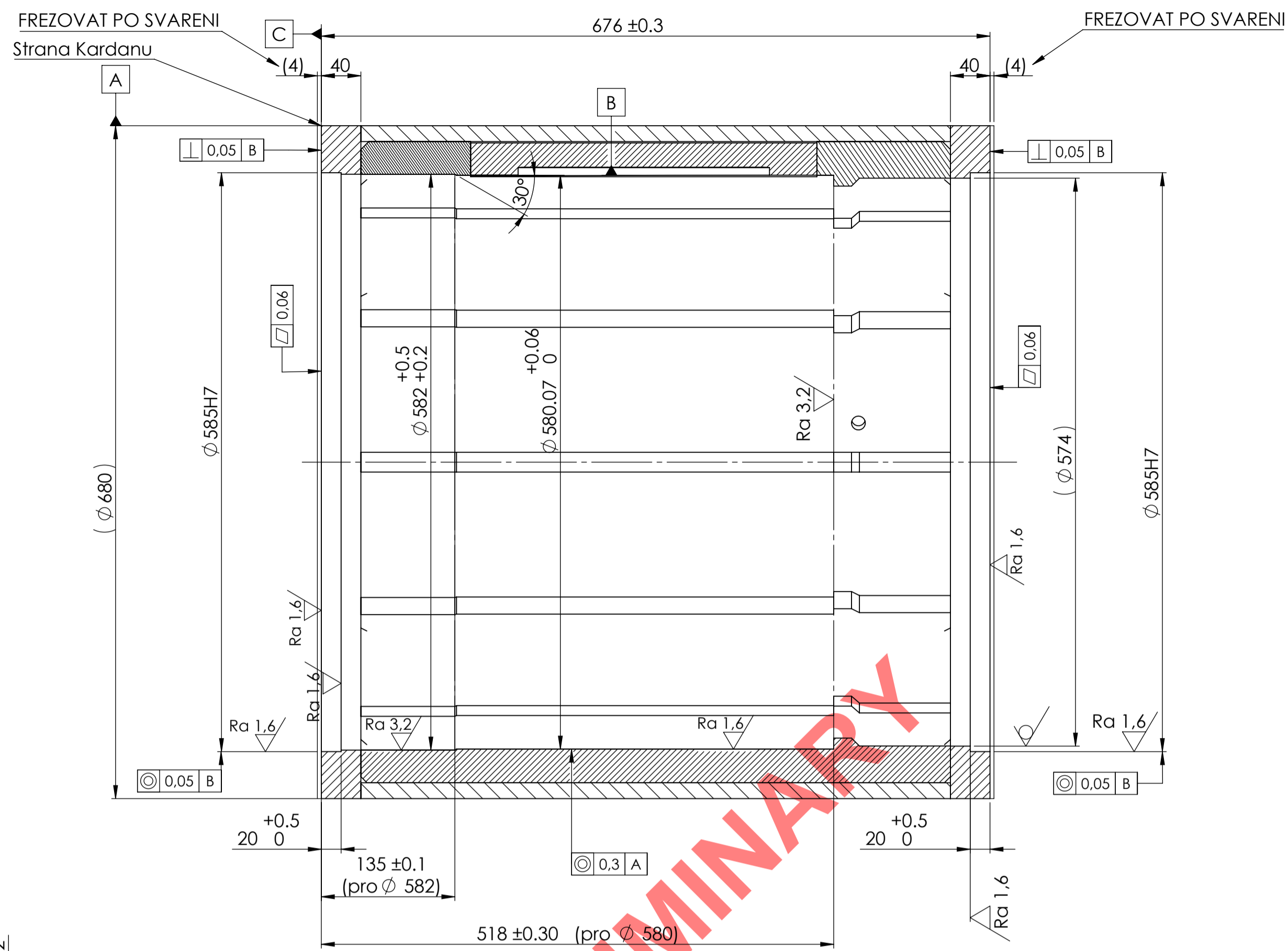
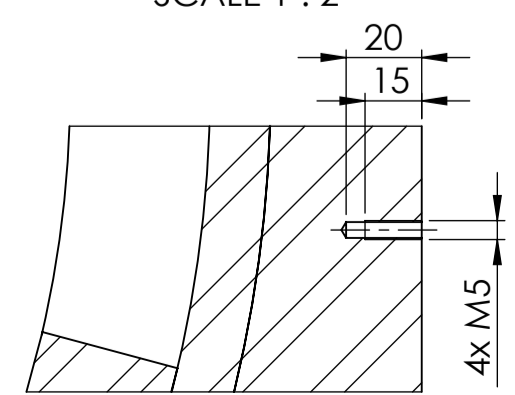

FREZO VAT PO SVARENI
Strana Kardanu

FREZO VAT PO SVARENI

PRELIMINARY

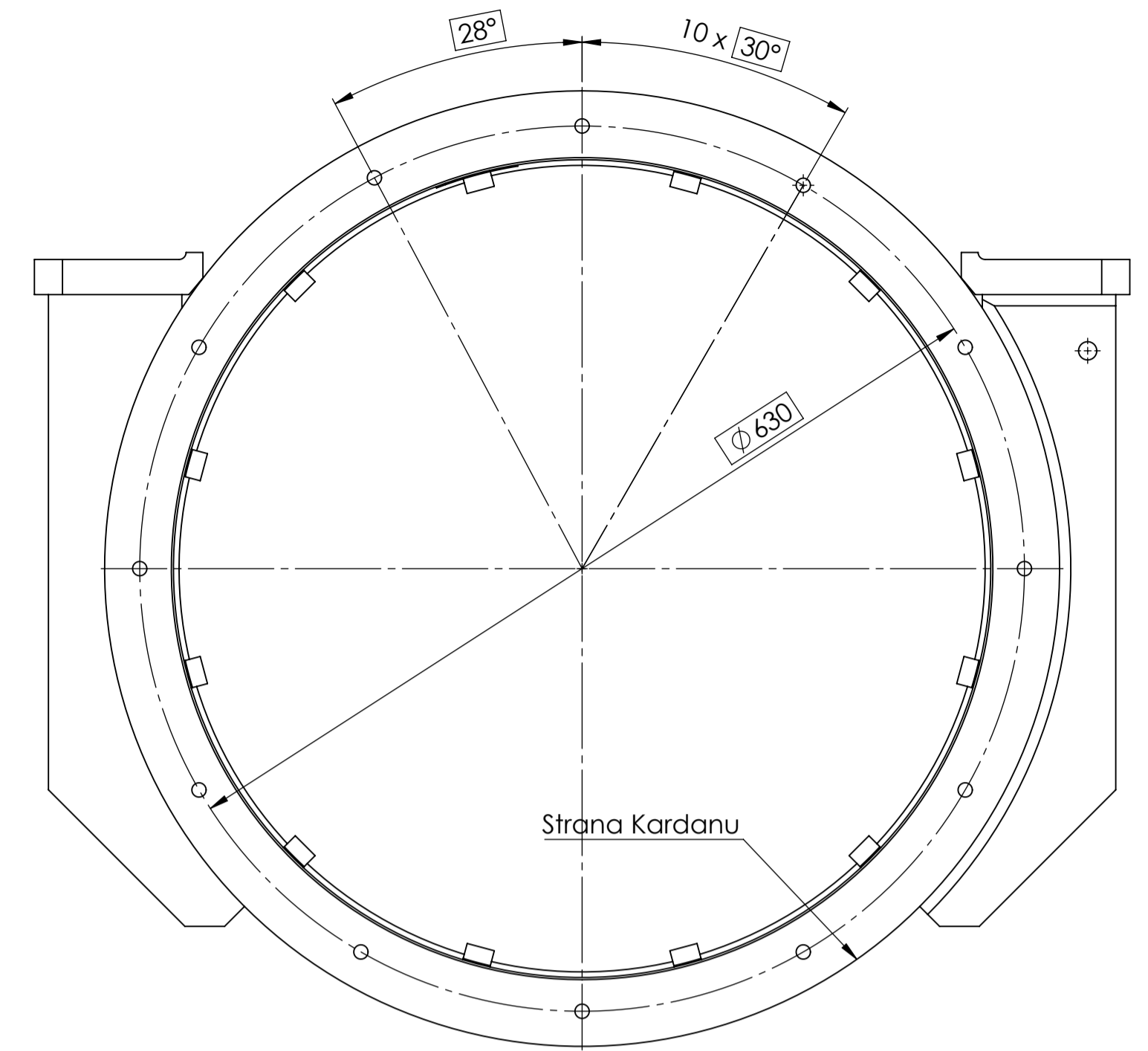

ŘEZ B-B
Otočeno 90°

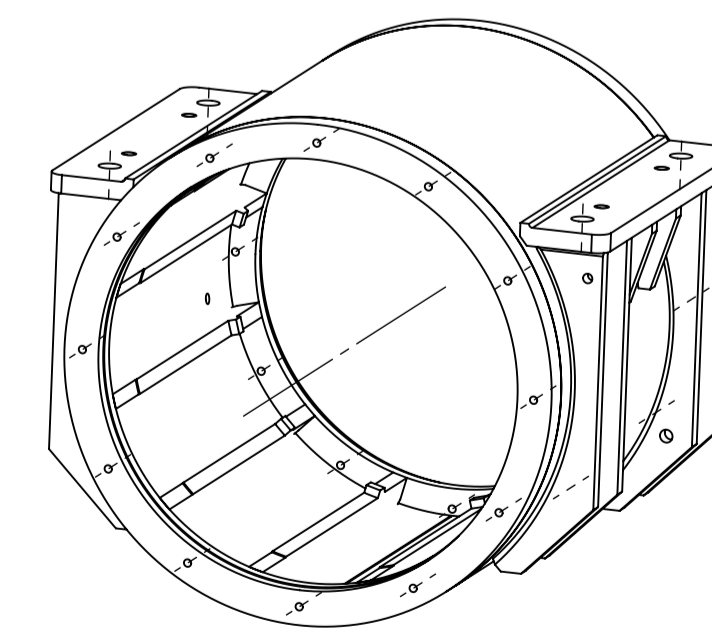
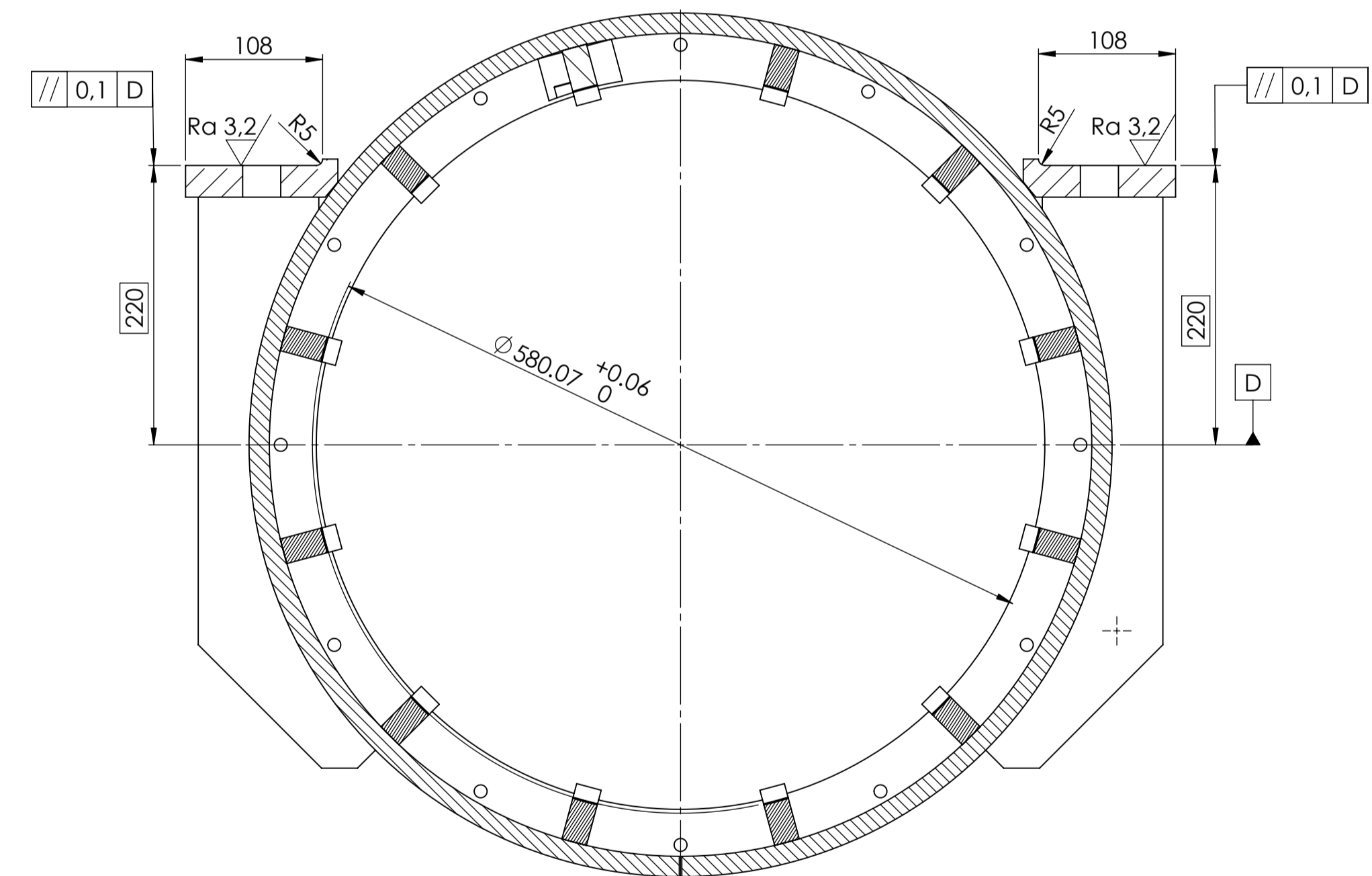

Strana Kardanu

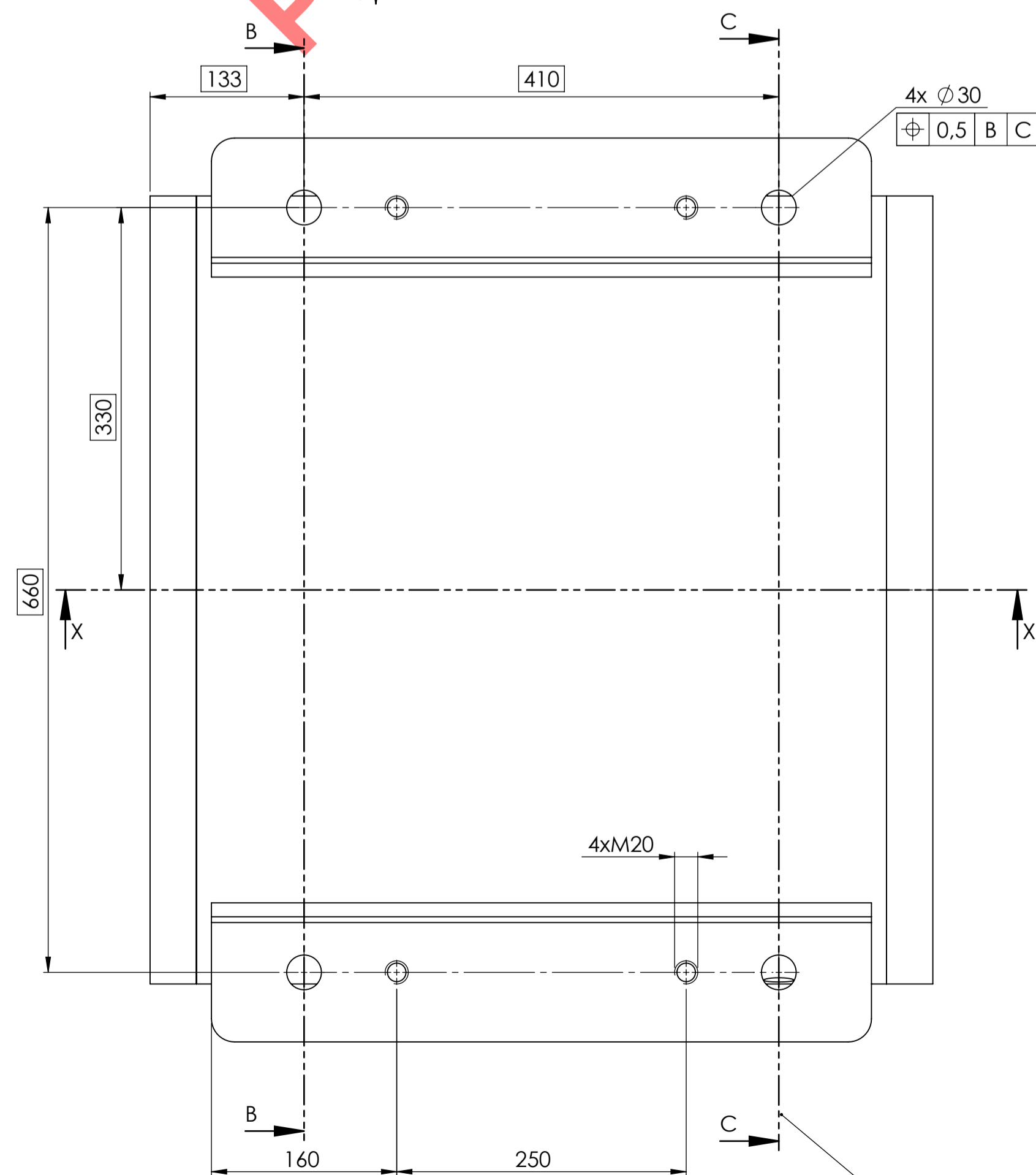
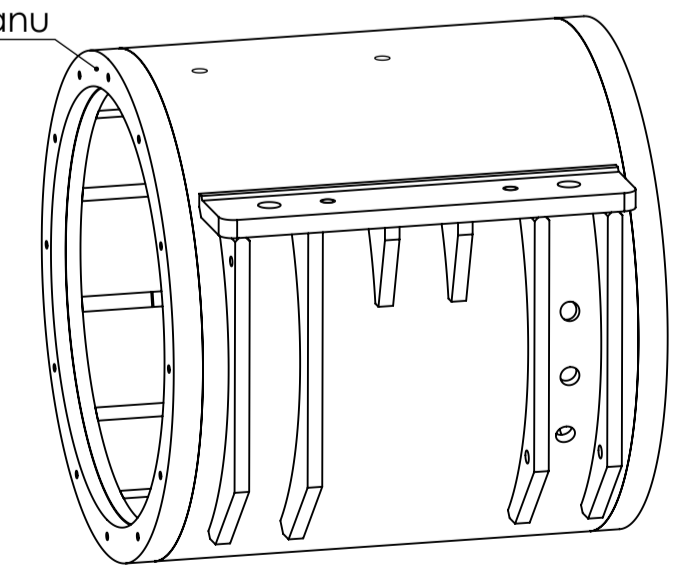

List 2

Průběh/Representation	TKL ISO 8015 ISO 2768-mK ISO 9013-442 CSN EN 1708 ISO 8062 - CT	ČISTŘENÍ ČISTĚ HRANY R0.5	MATERIÁL/MATERIAL: S355JR	HMOTNOST/WEIGHT: 320 Kg
Kresl/Drower	M. Hrubý	25.9.2015	PŮJČOVÁNÍ/PRODUCT: Svářeňec - 01-02-01-01-01	
Kontrola/Cont.			NÁZEV/NOME: Stator Frame-mach. Stator kostry - obrobek	
Schvál/Approved			Solidworks 2015	
			C. VYKRESLUNO: 01-02-01-01	
			MĚŘITKO/SCALE 1:5 LIST 1 Z 1 LISTŮ	

ŘEZ C-C

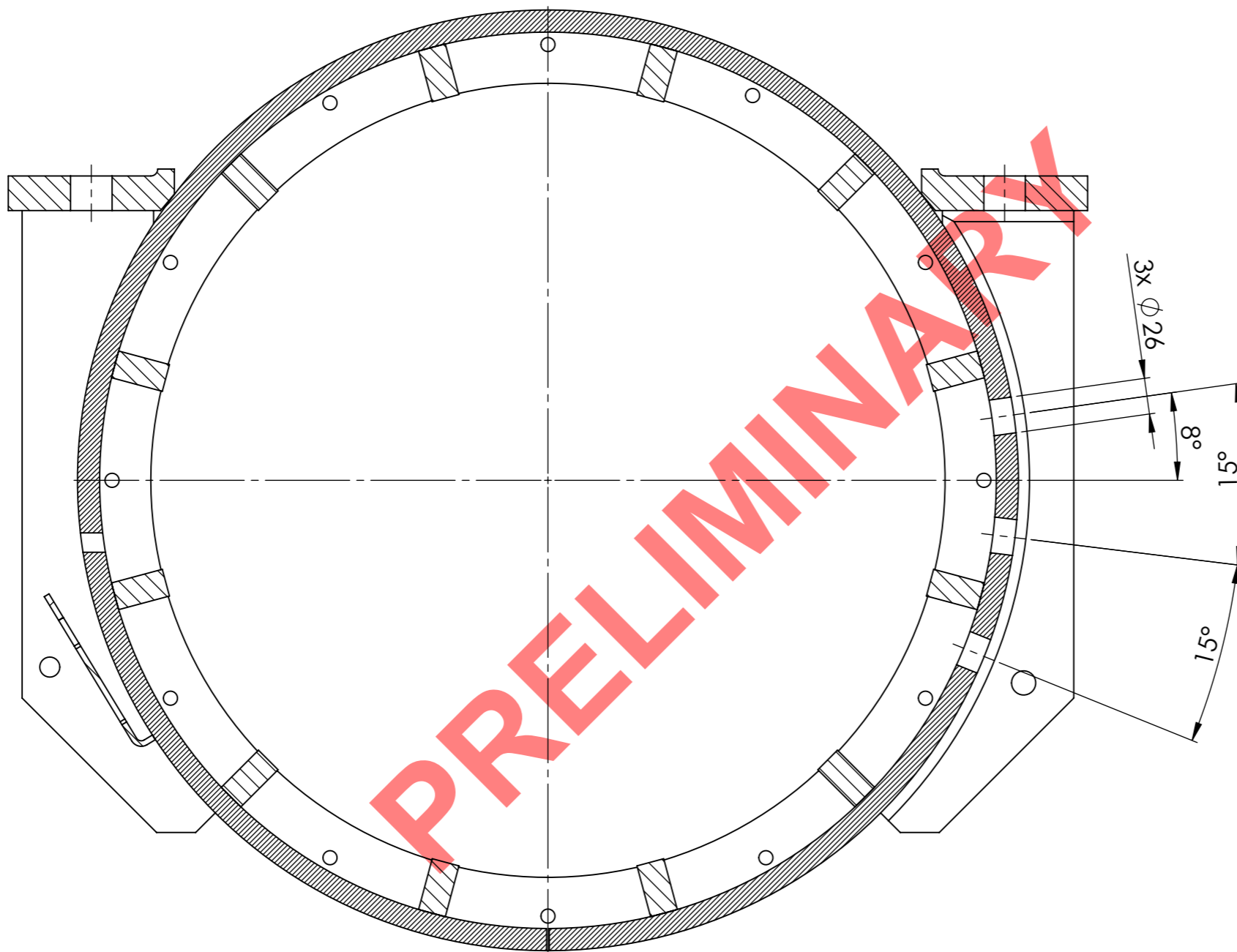

Promítání/Representation 		TOL. ISO 8015 ISO 2768-mK ISO 9013-442 ČSN EN 1708 ISO 8062 - CT		ODSTRANIT OSTRÉ HRANY R 0,5	MATERIÁL/MATERIAL: S355JR HMOTNOST/WEIGHT: 320Kg
POLOTOVAR/PRODUCT: Svařenec - 01-02-01-01-01					
NÁZEV/NAME: Stator Frame-mach. Stator kostry - obrobek					
Jméno/Name Kreslil/Drawed: J.Denk Kontroloval/Cont. Schválil/Approved		Podpis/Signature Datum/Date: 25.10.2015		Č. VÝKRESU/No. 01-02-01-01	
Solidworks 2015		Stat. Poznámka/Notice Datum/Date		A3	
MĚŘÍTKO/SCALE 1:5					LIST 2 Z 1 LISTŮ